

更改 REV	数量 MODIFICATION
A	ECXXXX

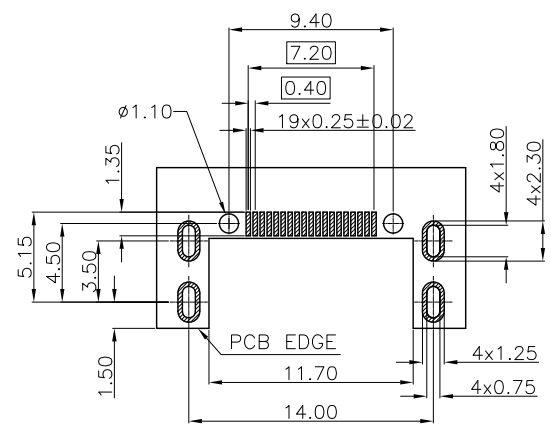

RECOMMENDED PCB LAYOUT
GENERAL TOLERANCES:±0.05

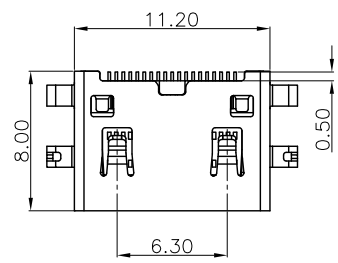
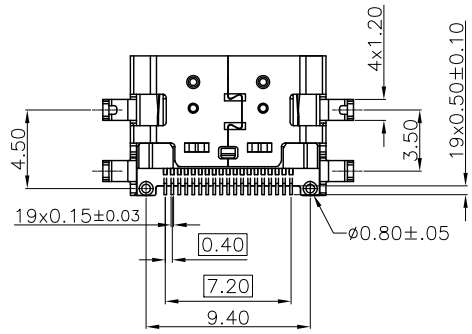
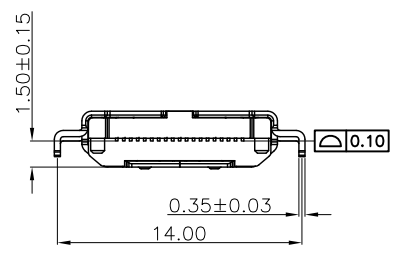
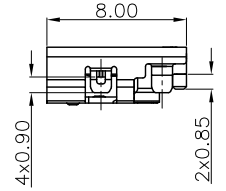
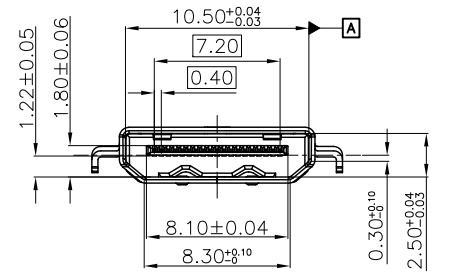

NOTES:

- 1.ELECTRONIC:
CONTACT RESISTANCE: 30mohm MAX
INSULATION RESISTANCE: 1000 Mohm MIN
WITHSTAND VOLTAGE:AC 500V,1min.
- 2.MECHANICAL:
DURABILITY: 10000 CYCLE.
- 3.ENVIRONMENT CHARACTERISTICS:
OPERING TEMPERATURE:-55°C TO +105°C
- 4.RECOMMANDER PCB THICKNESS 1.0 TO 1.20MM

GENERAL TOLERANCE		KINGCONN 皇海科技股份有限公司
X± 0.50	X*± 5 °	
.X± 0.30	.X*± 2 °	
.XX± 0.20	.XX*± 1 °	名称(TITLE) HDMI C FEMALE SMT 沉板 H1.50(平口)
单位(UNIT)	料号(PART NO.)	图号(DWG. NO.)
mm	7HDMI-F0-0007	7HDMI-F0-0007
审核(APPROVAL)	核数(CHECKED)	製版(DRAWN)
		比例 SCALE 1:1
		张数 SHEET 1/1
		更改 REV A

