

更改 REV	變更內容 MODIFICATION
A	ECXXXX

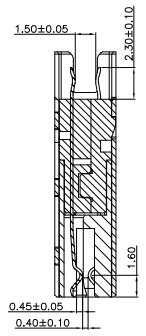

NOTES:
 1.MATERIAL:
 1-1.HOUSING: LCP, COLOUR:BLACK, UL94-V0.
 1-2.INSERTMOLDING: LCP, COLOUR:BLACK, UL94-V0.
 1-3.CONTACT: COPPER ALLOY, GOLD PLATING IN CONTACT AREA, 100u" Min. Tin PLATED ON SOLDER TAILS. 50u" Min. NICKEL PLATED OVERALL.
 1-4.SHELL: STAINLESS STEEL. 50u" Min. NICKEL PLATED OVERALL.
 2.ELECTRICAL CHARACTERISTICS:
 2-1. CURRENT RATING: 0.5A
 2-2. CONTACT RESISTANCE: 30mΩ MAX.
 2-3. INSULATION RESISTANCE: 100MΩ MIN.
 2-4. DIELECTRIC WITHSTAND VOLTAGE: AC 500V/MINUTE.
 2-5. OPERATING TEMPERATURE RANGE: -25°C~+85°C
 3.MECHANICAL CHARACTERISTICS:
 3-1. INSERTION FORCE: 4.0Kgf MAX.
 3-2. EXTRACTION FORCE: 0.7Kgf MIN.,2.5Kgf MAX.
 4.DURABILITY: 10000 CYCLES.

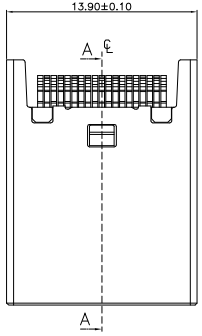
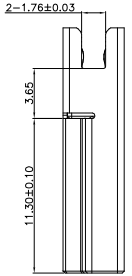
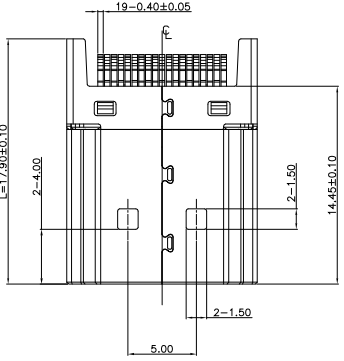
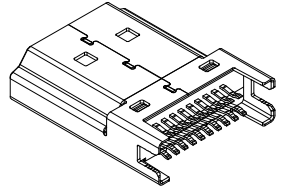
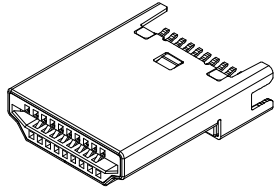
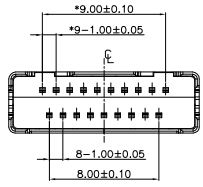
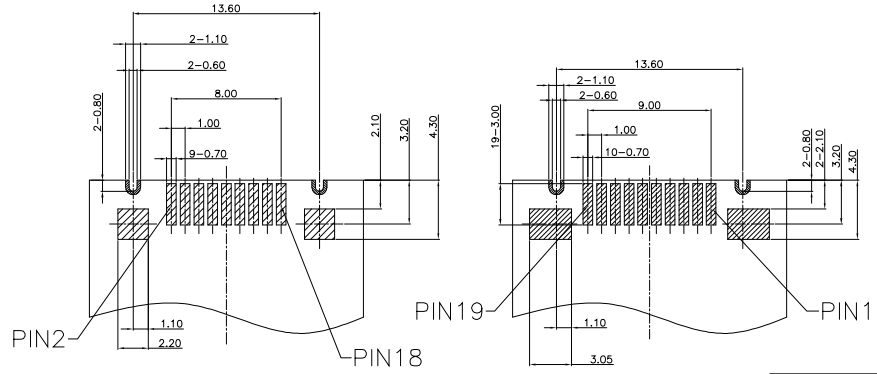
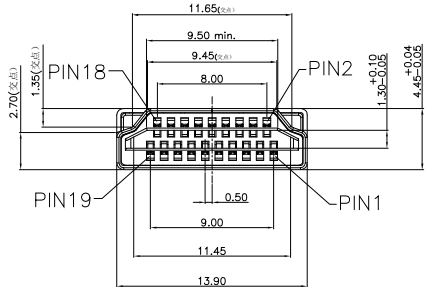

TOP SIDE
 BOTTOM SIDE
 RECOMMENDED PCBA TOLERANCE±0.05MM

GENERAL TOLERANCE		KINGCONN 皇海科技股份有限公司	
X± 0.50	X*± 5°	名 稱/TITLE HDMI AM 夾板式 FOR 2.1版	
.X± 0.30	.X*± 2°		
.XX± 0.20	.XX*± 1°		
單 位(UNIT) mm	料 號(PART NO.) 7HDMI-F0-0207	圖 號(DWG NO.) 7HDMI-F0-0207	比 例 SCALE 1:1
審 核(APPROVAL)	核 對(CHECKED)	製 圖(DRAWN)	張 數 SHEET 1/1
			角 註 PROJ. 更 改 REV A

