

更改 REV	變更內容 MODIFICATION
A	ECXXXXX

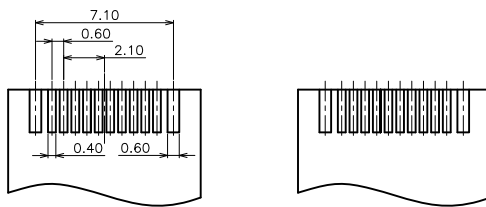

PCB LAYOUT

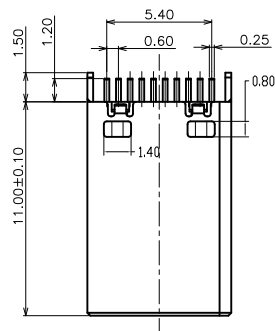
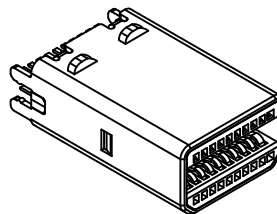
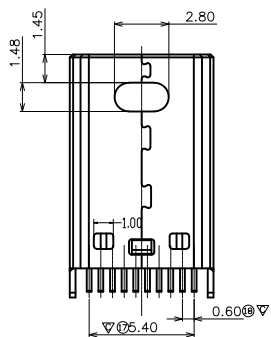
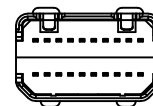
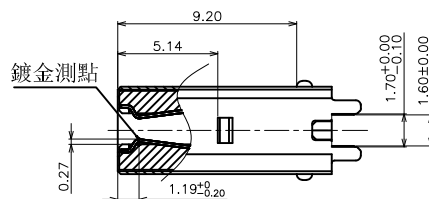
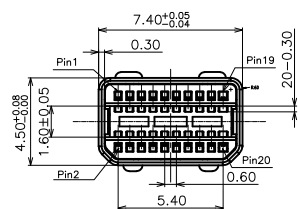

3D VIEW

備註:

- 材質
  - 端子: C5191 鍍GOLD FLESH半金霧錫;
  - 膠芯: MODING LCP 黑色; 主體 LCP白色;
  - 外殼: C2680 鍍金 鹽霧測試24H
- 電氣特性
  - 額定電壓:40VAC max.
  - 額定電流 :0.5A.
  - 接觸阻抗 :30Milliohms Max.
  - 絕緣阻抗 :100Megohms Min.
  - 耐電壓:300VAC.
- 機械特性
  - 插入力 :4.5Kgf max.
  - 拔出力:1.0~4.0Kgf.
  - 耐久:10,000 Cycles
- 環境特性
  - 應用溫度範圍:-40°C to +85°C
- 包裝: 吸塑盤

Top Row			Bottom Row		
Pin Number	Signal Type	Pin Name	Pin Number	Signal Type	Pin Name
1	GND	GND	2	In	HotPlug Detect
3	Out	ML_Lane 0(p)	4	CONFIG	CONFIG1
5	Out	ML_Lane 0(n)	6	CONFIG	CONFIG2
7	GND	GND	8	GND	GND
9	Out	ML_Lane 1(p)	10	Out	ML_Lane 3(p)
11	Out	ML_Lane 1(n)	12	Out	ML_Lane 3(n)
13	GND	GND	14	GND	GND
15	Out	ML_Lane 2(p)	16	I/O	AUX_CH(p)
17	Out	ML_Lane 2(n)	18	I/O	AUX_CH(n)
19	GND	GND	20	PWR Out	DP_PWR

GENERAL TOLERANCE		KINGCONN 皇海科技股份有限公司	
X± 0.50	X*± 5°	名 稱(TITLE) MINI DP 20PIN 公頭直通夾板 1.6	
.X± 0.30	.X*± 2°		
.XX± 0.20	.XX*± 1°		
單位(UNIT) mm	料 號(PART NO.) 7MNDP-F0-1012	圖 號(DWG NO.) 7MNDP-F0-1012	
審核(APPROVAL)	核 對(CHECKED)	製 圖(DRAWN)	比例 SCALE 1:1 張數 SHEET 1/1 更改 REV A

