

更改 REV	變更內容 MODIFICATION
A	EC06668
B	EC06956

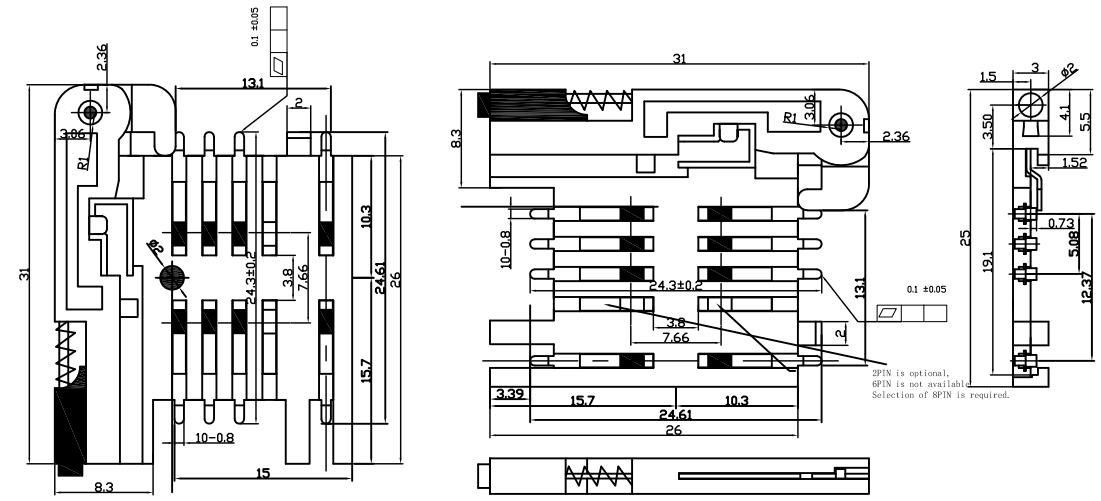

Structure:  
 1. Contact point material: Phosphor bronze.  
 2. Surface plating: contacts are gold plated, pins are tin plated, switch pins are gold plated.  
 3. Plastic part material: LCP.

Mechanical data:  
 1. Number of contacts: 8 pins.  
 2. life cycles: 5000 times.  
 3. Insertion force: 1-5 Kgf.  
 4. Pull-out force: greater than or equal to 3 Kgf.  
 5. Contact spring force: 0.2 Kgf ~ 0.6 Kgf.

Electronic characteristics:  
 1. Insulation resistance:  $\geq 1000 \text{ M}\Omega$ .  
 2. Contact resistance:  $\leq 0.1 \Omega$ .  
 3. Switch type: normally open.

Environmental data:  
 1. Working temperature:  $-40 \text{ }^\circ\text{C} \sim +85 \text{ }^\circ\text{C}$ .  
 2. Soldering conditions: the cover is separated from the base, reflow soldering at  $260 \text{ }^\circ\text{C} / 5$  seconds.  
 3. Humidity test: keep at  $40 \text{ }^\circ\text{C}$ , 90% ~ 96% humidity for 48 hours, product appearance is not significantly corroded.  
 4. Neutral salt spray experiment: keep in 5% NaCl solution at  $35 \text{ }^\circ\text{C}$  for 48 hours, product appearance is not significantly corroded.

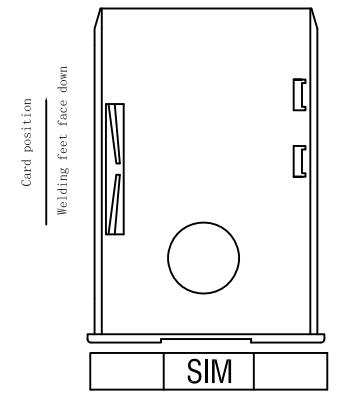

Card position  
Welding feet face down

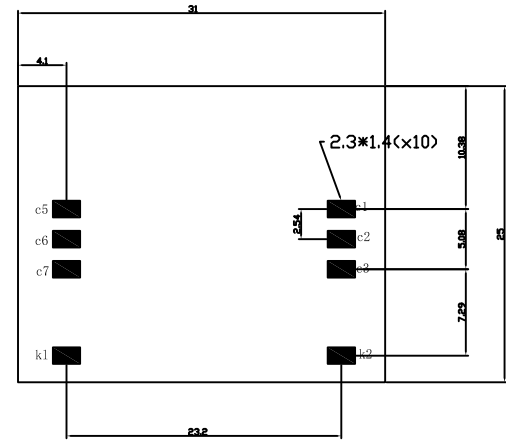

RECOMMENDED PCB LAYOUT



GENERAL TOLERANCE		KINGCONN	皇海科技股份有限公司
X, ± 0.50	X* ± 5°		
.X ± 0.30	.X* ± 2°		
XX ± 0.20	XX* ± 1°	名稱(TITLE) 推荐SIM卡座 抽屜SIM板上正插使用6+2PIN	
單位(UNIT) mm	料號(PART NO.) 7SIMC-AA-0008-B	圖號(DWG NO.) 7SIMC-AA-0008	
審核(APPROVAL)	核對(CHECKED)	製圖(DRAWN)	比例(SCALE) 1:1
			張數(SHEET) 1/2
			更改(REV) B

更改 REV	變更內容 MODIFICATION
A	EC06668
B	EC06956

SIM

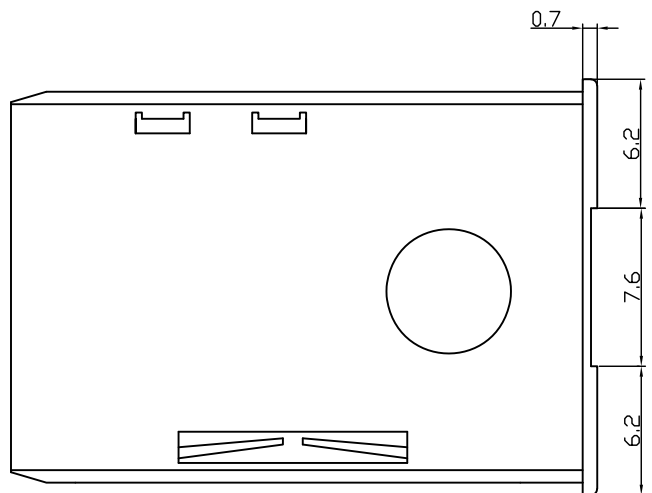
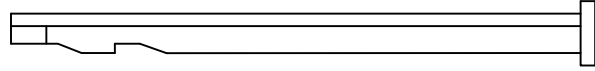
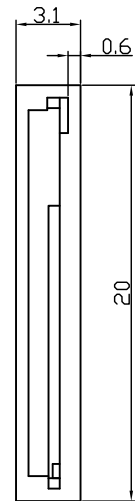
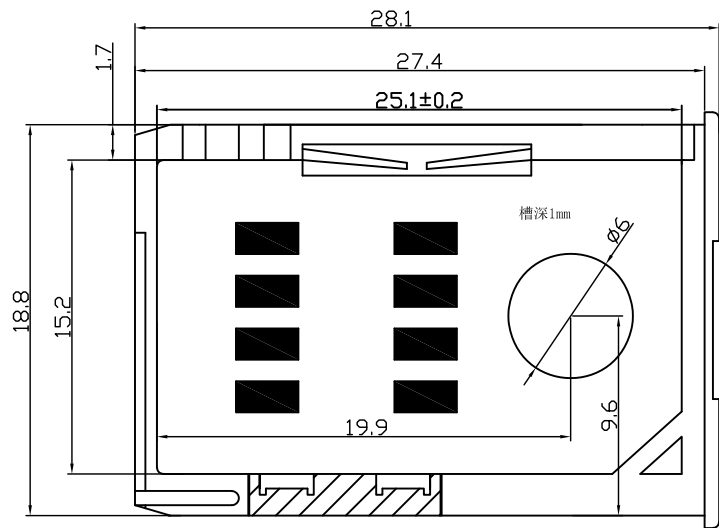

GENERAL TOLERANCE		KINGCONN 皇海科技股份有限公司	
X± 0.50	X*± 5°	名廠(TITLED) 推荐SIM卡座 抽屜SIM板上正插使用	
.X± 0.30	.X*± 2°		
.XX± 0.20	.XX*± 1°		
單位(UNIT) mm	料號(PART NO.) 7SIMC-AA-0008-B	圖號(DWG NO.) 7SIMC-AA-0008	圖數(SHEET) 2/2
審核(APPROVAL)	核對(CHECKED)	製圖(DRAWN)	比例(SCALE) 1:1
			更改(REV) B