

更改 REV	變更內容 MODIFICATION
A	ECXXXX

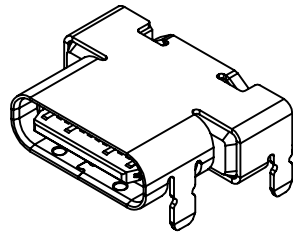

PIN ASSIGNMENT											
A1	A2	A3	A4	A5	A6	A7	A8	A9	A10	A11	A12
GND	SSTxp1	SSTxn1	VBUS	CC1	Dp1	Dn1	SBU1	VBUS	SSRxn2	SSRxp2	GND
GND	SSRxp1	SSRxn1	VBUS	SBU2	Dn2	Dp2	CC2	VBUS	SSRxn2	SSTxp2	GND
B12	B11	B10	B9	B8	B7	B6	B5	B4	B3	B2	B1

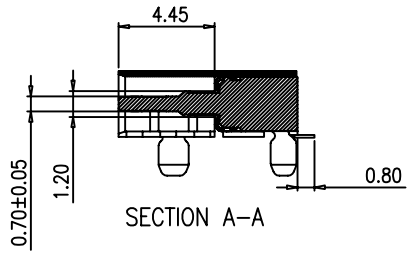

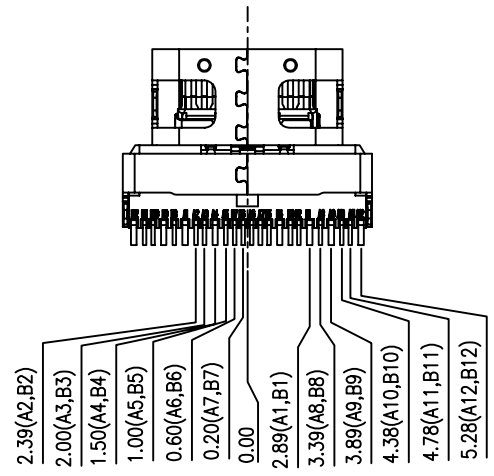
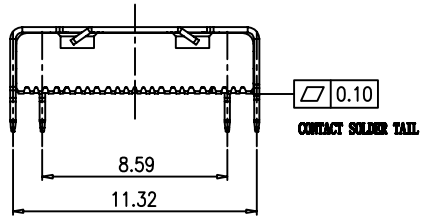
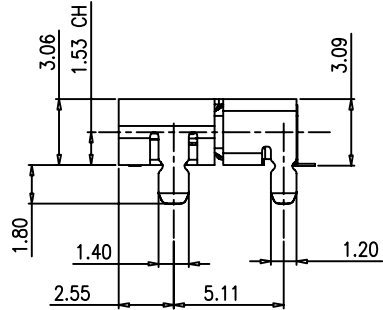
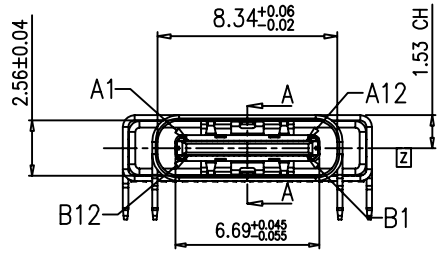
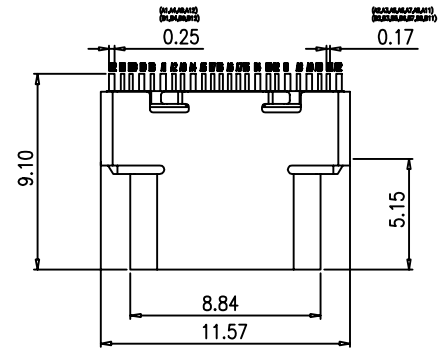

6	SHELL	1	SUS	SOLDER AREA G/F OVER NI 50u ² min
5	EMC	2	SUS	SOLDER AREA G/F OVER NI 50u ² min
4	MOLDING1	3	LCP E130I UL94V-0	BLACK
3	GROUND PLATE	1	SUS	CLEAN
2	DOWN CONTACT	12	ALLOY	CONTACT AREA Au 15u ² min ,SOLDER AREA G/F OVER NI 50u ² min
1	UP CONTACT	12	ALLOY	
ITEM	NAME	QTY	MATERIAC	FINISH

GENERAL TOLERANCE		KINGCONN 皇海科技股份有限公司	名 稱(TITLE)	
X± 0.50	X*± 5°		TYPE C 24PIN 15U " FOR 10G	
.X± 0.30	.X*± 2°			
.XX± 0.20	.XX*± 1°			
單位(UNIT)	料號(PART NO)	圖號(DWG NO)		
mm	7USB31-C0-1001	7USB31-C0-1001		
審核(APPROVAL)	核對(CHECKED)	製圖(DRAWN)	比例 SCALE 1:1	張數 SHEET 1/2
			圖號 REV A	

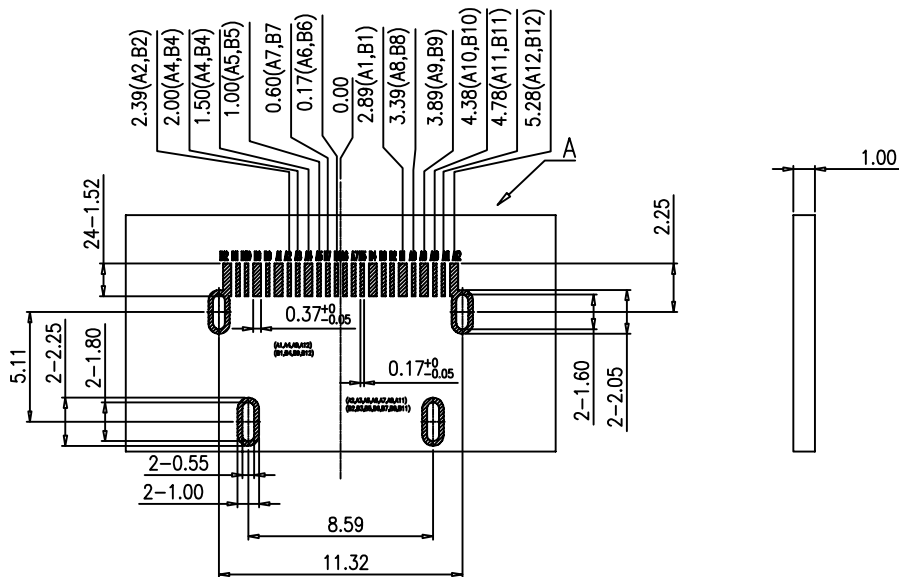

更改 REV	变更记录 MODIFICATION
A	ECXXXXX



RECOMMENDED P.C.B LAYOUT
TOP VIEW(TOLERANCE±0.05)
 PAD AREA

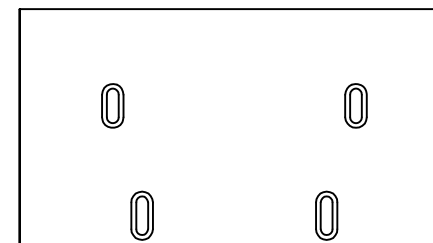

NOTES:

- Operating condition: Temperature -40°C ~ +85°C;
Humidity 80% R.H MAX
- MECHANICAL PERFORMANCE
 - Insertion Force: 5-20N .
 - Withdrawal Force: 8-20N. 1-1000 CYCLES
6-20N 1001-10000 CYCLES
 - Durability: 10000 Cycles Min.
- ELECTRICAL PERFORMANCE:
 - Rated voltage: AC 20V RMS
 - Rated current: 1.25A FOR (A1,A4,A9,A12,B1,B4,B9,B12)
0.25A FOR OTHER PER PIN
 - Contact Resistance: 40mΩ MAX

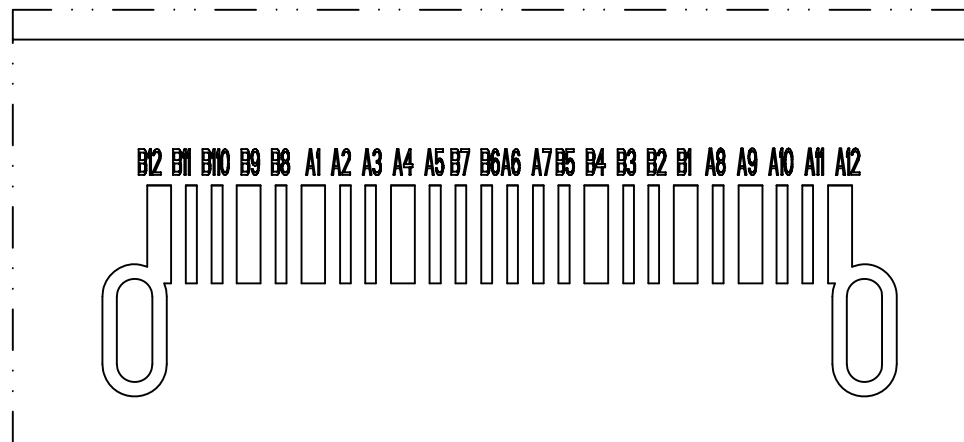

GENERAL TOLERANCE		KINGCONN 皇海科技股份有限公司
X± 0.50	X*± 5 °	
.X± 0.30	.X*± 2 °	
.XX± 0.20	.XX*± 1 °	名称(TITLE) TYPE C 24PIN 15U " FOR 10G
单位(UNIT) mm	料号(PART NO.) 7USB31-C0-1001	图号(DWG NO.) 7USB31-C0-1001
审核(APPROVAL)	核数(CHECKED)	製圖(DRAWND)
		比例(SCALE) 1:1
		张数(SHEET) 2 / 2
		更改(REV) A

