

更改 REV	註 修改內容 MODIFICATION
A	ECXXXXX

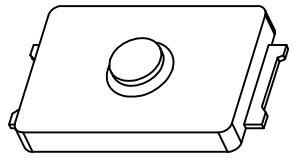

- 1.RATING: DC 12V,50mA Max
- 2.OPERATING FORCE: 200±40gf
- 3.TRAVEL: 0.15±0.05mm
4. LIFE: 100,000cycles
5. PACKAGE: 10000Pcs/Reel

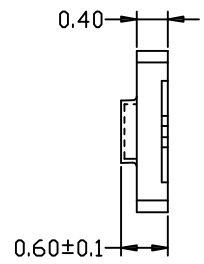
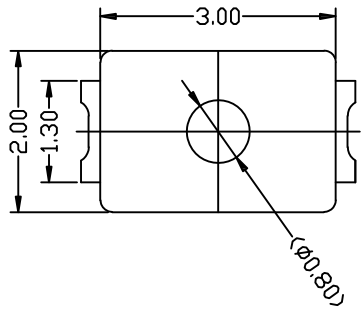
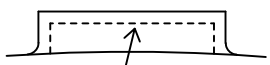
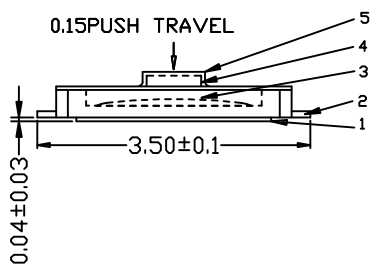

TEASCALE:2.5/1

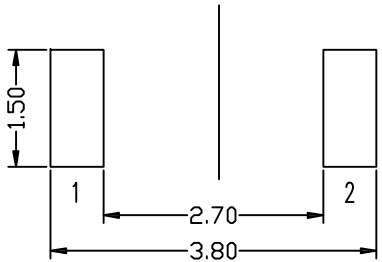

Recommended PAD Layout  $\phi \pm 0.05$   
Recommended solder thickness: T=0.10±0.01

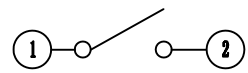

CIRCUIT DIAGRAM

6				
5	COVER	1	PI	YELLOW
4	KNOB	1	PI	BLACK
3	CONTACT	2	SUS	Ag-Plate
2	TERMINAL	2	PHOSPHOR BRONZE	Ag-Plate
1	CASE	1	LCP	BLACK
ITEM	PART NAME	Q'TY	MATERIAL	FINISH

GENERAL TOLERANCE		KINGCONN 皇海科技股份有限公司	
X± 0.50	X*± 5 °	名 稱(TITLE) <b>THIN FILM SWITCH</b>	
X± 0.30	X*± 2 °		
.XX± 0.20	.XX*± 1 °		
單 位(UNIT) mm	料 號(PART NO.) 7WHTF-F0-3079	圖 號(DWG NO.) 7WHTF-F0-3079	
審 核(APPROVAL)	核 對(CHECKED)	製 圖(DRAWN)	比 例 SCALE 1:1
			張 數 SHEET 1
			更 改 REV A

